



CUMMINS M-11 SERIES

Sleeve Removal & Installation Manual

IRONTITE PRODUCTS INC

2525 18th Str. SW, suite D, Cedar Rapids, Iowa 52404 USA
800-553-5953 · +1-319-377-9421 · www.ironTite.com

Rev. 160315 · Doc PN: 451-3540-07

CUMMINS M-11 STAINLESS STEEL INJECTOR SLEEVE REMOVAL & INSTALLATION KIT

Cummins has updated the M-11 Series Cylinder Heads from Copper Injector Sleeves and Small Viton O-Rings to **Stainless Steel Injector Sleeves with Large Viton O-Rings**

Tooling is **upgradeable** from existing Cummins L-10 Injector Sleeve Tooling.

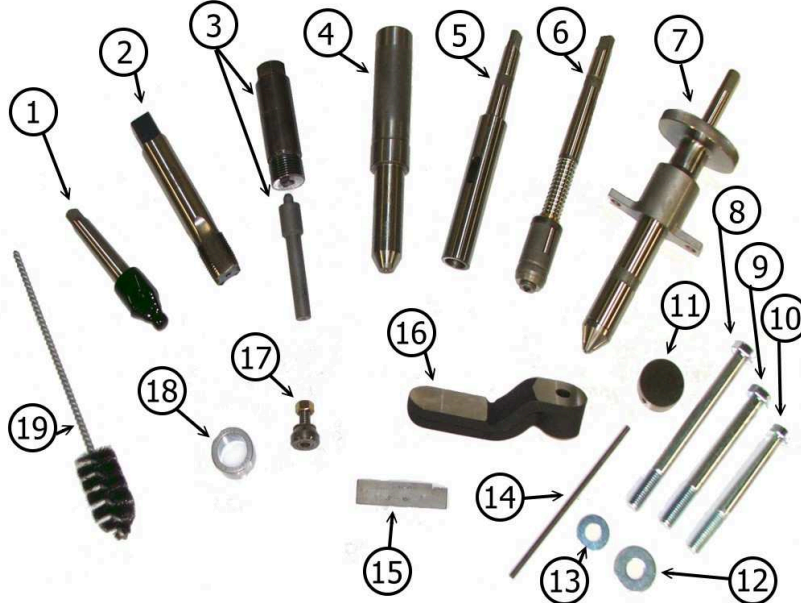

The Complete M-11 Series Kit with Toolbox - 450-6152-30

Image #	Description	Part #
1	Sleeve Seat Cutter (Carbide)	416-6152-27
2	M-11 Tap	437-5331-36
3	M-11 Complete Tool *Includes Tool Body & Mandrel *Sleeve Removal Tool Puller Body (415-6132-41) *Sleeve Removal Puller Mandrel (415-6132-49)	415-6132-40
4	Sleeve Drive In Tool	415-6152-61
5	Driving Arbor	414-6114-10
6	M-11 Sleeve Body Roll-in Tool	416-6152-43
7	M-11 Sleeve Nose Roll-in Tool	416-6152-45
8,9,10,12,13,16	Gauge Finger Assembly (This includes marked "←" items Below)	433-6991-00
8	½" - 13 x 6" Bolt ←	467-1686-00
9	½" - 13 x 5" Bolt ←	467-1685-00
10	½" - 13 x 4-½" Bolt ←	467-1684-50
11	Gauge	416-6152-98
12	½" U S S Washer ←	467-1520-50
13	½" SAE Washer ←	467-1520-51
14	Gauge Handle	414-6111-30
15	Flat Tip Protrusion Gauge	414-6111-19
16	Gauge Finger (Without Bolts & Washers) ←	433-6991-02
17	M-11 Injector Tube Clamp Assembly	416-6154-40
18	Guide Bushing	414-6114-36
19	Casting Cleaning Brush (Carbon Steel)	450-6951-02
	MicroFinish Tap & Lube (8 oz)	468-9910-08
	Tool Box	467-1950-50

ADDITIONAL AVAILABLE ITEMS

Description	Part #
M-11 Stainless Steel injector Sleeve	419-6192-41
Viton O-Ring	419-6192-42

Made in USA

REMOVAL and INSTALLATION

Sleeve Removal

- 1) Install the sleeve hold down clamp (416-6154-40) through the inside of the sleeve. Install washer and nut onto stud sticking out from face of head and tighten.
- 2) The clamp will keep the sleeve from turning while tapping the sleeve.
- 3) Using tap (437-5331-36) and guide bushing (414-6114-36), lubricate the tap with MicroFinish (468-9910-08) while tapping the injector sleeve about 3/8" to 1/2" deep.
- 4) Unbolt and remove the hold down clamp. Install puller mandrel (415-6132-49), long end through the sleeve from the top side of the head then thread the sleeve puller body (415-6132-41) into the tapped sleeve.
- 5) Turn the head over. Using a hydraulic press, press on the mandrel to push the sleeve from the head.

Sleeve Installation

- 1) Use the carbon steel brush (450-6951-02) to clean the inside of the injector sleeve bore. Be sure to remove the old "O" ring and replace it with a new one available from Irontite Products (419-6192-42).
- 2) Use the Sleeve Drive-In Tool (416-6152-61) and a hammer to drive the Sleeve (419-6192-41) to the bottom of the casting.
- 3) Use the Sleeve Nose Roll-In tool (416-6152-45). Back off the hand knob before installing the tool into the head. Bolt the tool to the head using the two bolts provided. You can use a drill motor or a seat and guide machine to drive the tool.
- 4) Turning the tool at a slow RPM (40-60rpm), turn the knob clockwise, rolling the nose of the sleeve in.
- 5) Use the Sleeve Body Roll-In Tool (416-6152-43) to roll in the upper end of the injector sleeve. This can also be done using a seat and guide machine.
- 6) Roll in the upper end of the sleeve by running the machine clockwise and letting the roll-in tool feed itself.
- 7) To remove the tool, reverse the machine.
- 8) Using the Sleeve Nose Roll-In Tool (416-6152-45) repeat step (3) of Sleeve Installation.

Cutting Injector Tip Protrusion

- 1) Set up the Guide Bushing (414-6114-36), Sleeve Seat Cutter (416-6152-27) and the Driving Arbor (414-6114-10) in a seat and guide machine. Bolt the Gauge Finger (433-6991-00) to the face of head. Set the Gauge (416-6152-98) with the Gauge Handle (414-6111-30) onto the Gauge Finger.
- 2) Use a good cutting fluid like our MicroFinish (468-9910-08). Run the machine at a slow RPM (40-60rpm) and you may have to vary the speed to get a good finish.
- 3) Cut the Sleeve until the pilot end of the Cutter touches the Gauge.
- 4) You can check the tip protrusion with the Flat Tip Protrusion Gauge (414-6111-19) and the Injector.
- 5) The protrusion should be between the steps of the gauge.

Note: It is always a safe practice to install an injector with Prussian Blue Compound applied at the Seat Area to insure proper seating of Injector.



Irontite Products Inc.
2525 18th Street SW, Suite D, Cedar Rapids, IA 52404 USA
800-423-3384
+1-319-377-9421
FAX 319-377-9101
www.irontite.com